

► DECK COLLAR

COMPONENTS

2004

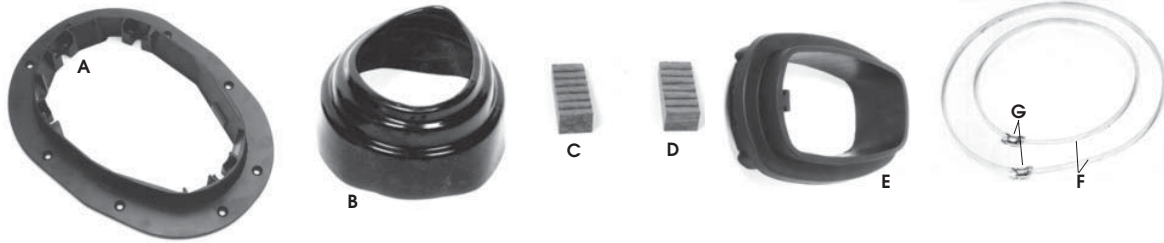

Profile	Complete set	A	B	C		D		E		F		Mast Deck collar	H		I
		Cast collar	Coat	Small wood wedges	Qt	Large wood wedges	Qt	Mold wedges	Ref.	ml	Clamp		Qt	Bale	
F78		36061200783													
F135	36061201355	36061201353	36073560119	36072000001	x 2	36072000002	x 1			36071225010	x 0,47	x 0,7	36071200000	x 2	47505558124
F195	36061201955	36061201353	36073560120	36072000001	x 3					36071225010	x 0,52	x 0,7	36071200000	x 2	47505558124
F305	36061203055	36061203853	36073560121	36072000001	x 6					36071225010	x 0,58	x 0,77	36071200000	x 2	47505558124
F385	36061203855	36061204603	36073560122	36072000001	x 4					36071225010	x 0,61	x 0,77	36071200000	x 2	47505558124
F460	36061204615	36061204603	36073560122	36072000001	x 4					36071225010	x 0,64	x 0,77	36071200000	x 2	47505558124
F580	36061205805	36061246743	36073191028					36072000580	36071225010	x 0,67	x 0,89	36071200000	x 2		
F740	36061207405	36061246743	36073191028					36072000740	36071225010	x 0,71	x 0,89	36071200000	x 2		
F1060	36061210605	36061110603	36073191017			36072000002	x 3		36071225010	x 0,77	x 1	36071200000	x 2		
F1395	36061213955	36061110603	36073191017					36072001395	36071225010	x 0,83	x 1	36071200000	x 2		

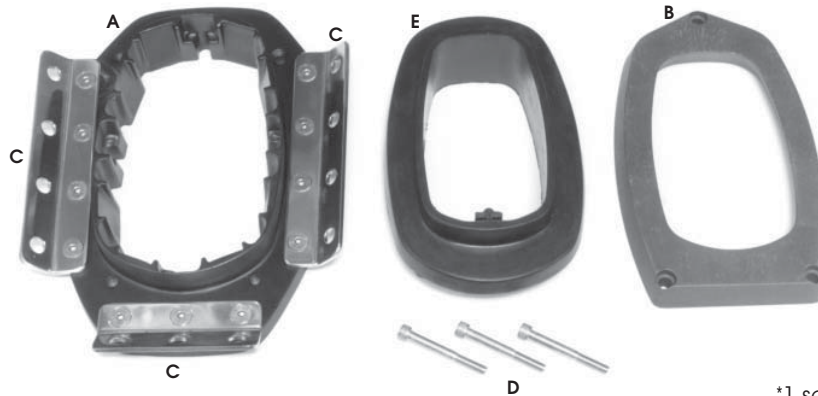

*1 set of 3 s/s plates

New style

Profile	Complete set	A	B	C		D		E	Fastening			
		Cast collar	Clamp	S/s block attachment	Qt	Clamp fastening	Qt	Mold wedges	Qt	Qt	Qt	
F305	36069203055	36069203053	36075103853	36075303855	1	28600610070	3	36072000305	28604010025	x 10	28604010060	x 1
F385	36069203855	36069203053	36075103853	36075303855	1	28600610070	3	36072000385	28604010025	x 10	28604010060	x 1
F460	36069204605	36069204603	36075104603	36069204604	1	28600610080	3	36072000460	28601110025	x 9	28601110040	x 2
F580	36069205805	36069204603	36075105803	36069204604	1	28600610080	3	36072000580	28601110025	x 9	28601110040	x 2
F740	36069207405	36069204603	36075107403	36069204604	1	28600610080	3	36072000740	28601110025	x 9	28604010040	x 2
F1060	36069210605	36061110603	36075110603	36069204604	1	28605008050	4	36072001060	28601110025	x 9	28601110040	x 2
F1395	36069213955	36061110603	36075113953	36069204604	1	28605008050	4	36072001395	28601110025	x 9	28601110040	x 2

► DECK COLLAR

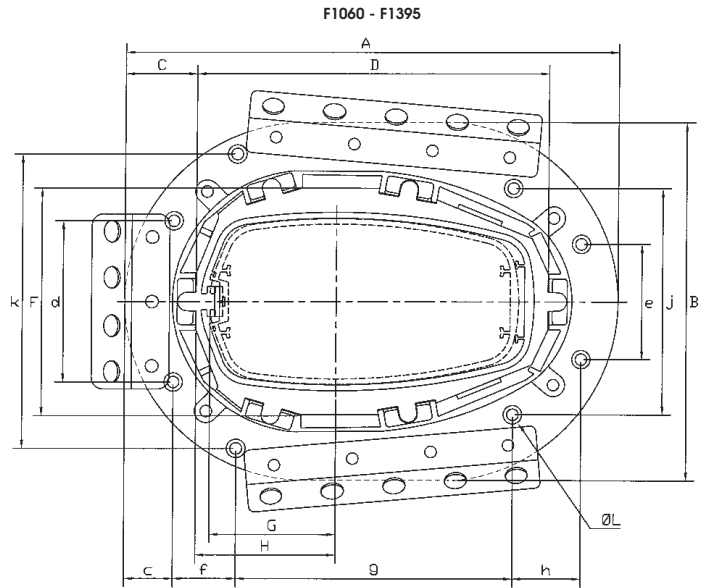
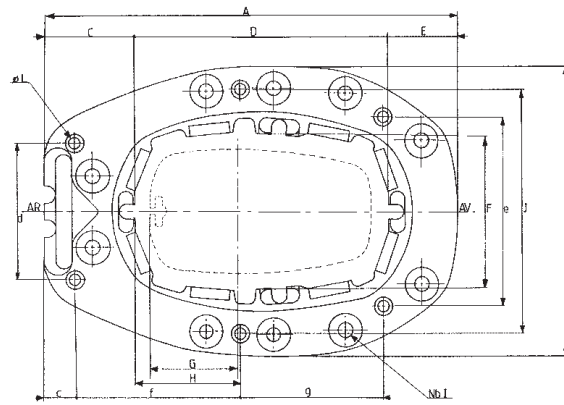

2004

► MAIN DIMENSIONS

Extrusion	G	H	A	B	C	D	E	F	c	d	e	f	g	h	Nb i	j	k	Ø L
F78	49	52	160	142							88					108		
F135	57	85	323	228	78	186	59	111	27	115	150	129	108		10	190		8,5
F195	65	79	323	228	78	186	59	111	27	115	150	129	108		10	190		8,5
F305	74	88	351	245	75	216	60	127	28	115	158	140	120		10	205		8,5
F385	82	90	351	245	75	216	60	127	28	115	158	140	120		10	205		8,5
F460	88	92	351	245	70	226	54	127	28	115	158	140	120		10	205		8,5
F460	88	120	400	254	74	270	56	148	26	115	172	173	128		10	220		8,5
F580	90	108	400	254	74	270	56	148	26	115	172	173	128		10	220		8,5
F740	100	108	400	254	74	270	56	148	26	115	172	173	128		10	220		8,5
F1060	108	178	423	310	61	301		197	42	140	100	54	236	59	*	196	255	10,5
F1395	115	179	423	310	61	301		197	42	140	100	54	236	59	*	196	255	10,5

*S/s block attachment : see page 34

► INTERNAL WATER-PROOFING

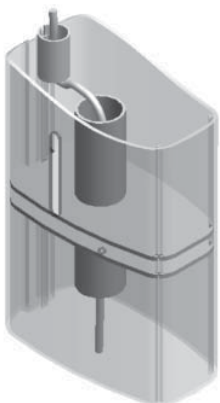

Extrusion	Reference
IMS80	35502000080
F78	35502000078
F135	35502000135
F195	35502000195
F305	35502000305
F385	35502000385
F460	35502000460
F580	35502000580
F740	35502000740
F1060	35502001060
F1395	35502001395
F2390	35502002390
F3360	35502003360